

SB Series

FEATURES

- Compared with the SA series of smaller size, higher Ripple Current
- Load Life 2000 hours at 85°C
- Applications: Frequency converters and UPS
- Compliant to the RoHS directive

- 比SA系列体积更小、纹波更高
- 85°C 2000小时
- 应用：变频器、不间断电源等
- RoHS指令对策品



◆规格表 SPECIFICATIONS

项目 Items	特性 Characteristics										
工作温度范围 Operating Temperature Range	- 25 ~ +85°C										
额定工作电压范围 Rated working voltage range	350 ~ 500V										
静电容量范围 Capacitance Range	470 ~ 18000µF										
静电容量允许偏差 Capacitance Tolerance	±20% (20°C, 120Hz)										
损耗角正切值 Dissipation Factor (MAX) 20°C , 120Hz	<table border="1"> <tr> <td>U_R(V)</td> <td>350</td> <td>400</td> <td>450</td> <td>500</td> </tr> <tr> <td>tanδ</td> <td colspan="2">0.15</td> <td colspan="2">0.20</td> </tr> </table>	U _R (V)	350	400	450	500	tanδ	0.15		0.20	
U _R (V)	350	400	450	500							
tanδ	0.15		0.20								
漏电流 Leakage Current (MAX)	I = 0.01C _R U _R 或 5mA 取小者 (20°C , 施加额定电压 5 分钟后) I = 0.01C _R U _R or 5mA whichever is minimum. (at 20°C , After 5 minutes application of rated voltage) I = 漏电流 (µA) U _R = 额定电压 (V) C _R = 静电容量 (µF) Leakage Current Rated Voltage Rated Capacitance										

	使用寿命 Useful Life	负荷寿命 Load Life	耐久性特性 Endurance Test	高温无负荷特性 Shelf Life
产品寿命 Life Time	4000h	>65000h	2000h	1000h
漏电流 Leakage Current	≤规定值 ≤Specified value	≤规定值 ≤Specified value	≤规定值 ≤Specified value	≤规定值 ≤Specified value
损耗角正切值变化率 tanδ Change	≤规定值的 300% ≤300% of specified value	≤规定值的 175% ≤175% of specified value	≤规定值的 130% ≤130% of specified value	≤规定值的 150% ≤150% of specified value
静电容量变化率 Capacitance Change	初始值± 30%以内 Within±30% of initial value	初始值±15%以内 Within±15% of initial value	初始值±10%以内 Within±10% of initial value	初始值±15%以内 Within±15% of initial value
施加条件 Condition 施加电压 Applied Voltage 施加纹波电流 Applied Ripple Current 环境温度 Applied Temperature 失效等级 Failure Rate Level	U _R I _R 85°C ≤1% Failure rate	U _R 1.2×I _R 40°C ≤1% Failure rate	U _R I _R 85°C 0%	U _R I _R 85°C 0% Back up to 20°C and placed more than 24 hours. U _R to be applied for 60 min before measurement.

◆尺寸图 Dimensions

- 常用端子型式代码：Terminal Code

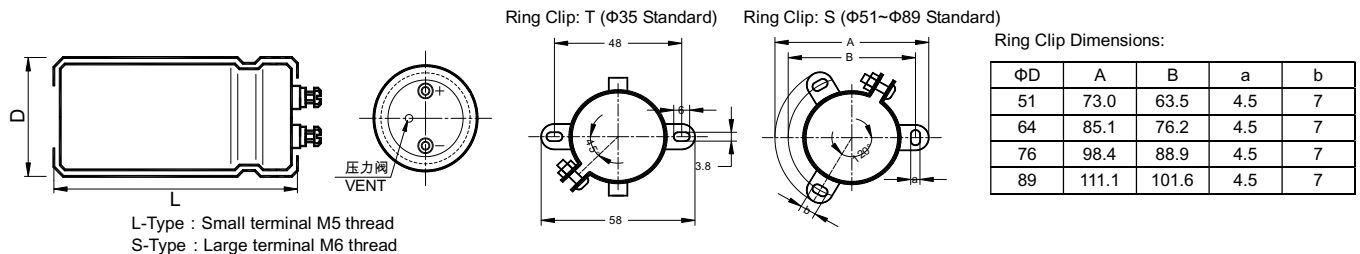

- 记载以外的端子形状，请另行咨询。Please consult to us for the terminal type not displayed in content.

◆产品编码体系 PART NUMBER SYSTEM

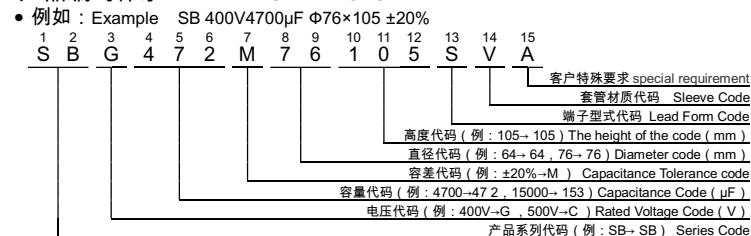

◆纹波电流修正系数 Rated Ripple Current Multiplies

● 频率修正系数 Frequency coefficient

频率 Frequency (Hz)	50(60)	100(120)	300	1k	≥10k
系数 Coefficient	0.80	1.00	1.10	1.25	1.50

● 温度修正系数 Temperature coefficient

温度 Temperature (°C)	+40	+60	+70	+85
系数 Coefficient	2.70	2.00	1.70	1.00

SB Series

◆产品一览表 Standard Ratings

WV _{DC} (Surge Voltage) (V)	Cap (μ F)	Size D×L (mm)	tan δ 20°C/120Hz	Ripple Current 85°C/120Hz (Arms)	Catalog Part Number
350 (400)	1500	51×70	0.15	5.7	SBH152M51070□VA
	1800	51×80	0.15	6.7	SBH182M51080□VA
	2200	51×95	0.15	8.0	SBH222M51095□VA
	2700	51×115	0.15	9.5	SBH272M51115□VA
	3300	64×90	0.15	10.7	SBH332M64090□VA
	3900	51×130	0.15	11.8	SBH392M51130□VA
	3900	64×95	0.15	11.9	SBH392M64095□VA
	4700	64×115	0.15	13.2	SBH472M64115□VA
	5600	64×130	0.15	15.2	SBH562M64130□VA
	5600	76×95	0.15	15.0	SBH562M76095□VA
	6800	76×115	0.15	17.5	SBH682M76115□VA
	8200	76×130	0.15	20.3	SBH822M76130□VA
	10000	76×155	0.15	22.5	SBH103M76155□VA
	12000	89×130	0.15	25.0	SBH123M89130□VA
15000	89×157	0.15	29.0	SBH153M89157□VA	
18000	89×195	0.15	34.1	SBH183M89195□VA	
400 (450)	1000	51×60	0.15	4.5	SBG102M51060□VA
	1200	51×70	0.15	4.9	SBG122M51070□VA
	1500	51×80	0.15	6.1	SBG152M51080□VA
	1800	51×90	0.15	6.7	SBG182M51090□VA
	2200	51×105	0.15	7.8	SBG222M51105□VA
	2700	51×115	0.15	9.8	SBG272M51115□VA
	3300	64×95	0.15	10.6	SBG332M64095□VA
	3900	64×105	0.15	12.0	SBG392M64105□VA
	3900	64×110	0.15	12.2	SBG392M64110□VA
	3900	64×115	0.15	12.4	SBG392M64115□VA
	4700	64×120	0.15	13.4	SBG472M64120□VA
	4700	64×130	0.15	13.9	SBG472M64130□VA
	4700	76×105	0.15	14.2	SBG472M76105□VA
	5600	64×155	0.15	16.1	SBG562M64155□VA
	5600	76×115	0.15	16.0	SBG562M76115□VA
	6800	76×115	0.15	16.4	SBG682M76115□VA
	6800	76×130	0.15	18.1	SBG682M76130□VA
	8200	76×130	0.15	18.5	SBG822M76130□VA
	8200	76×145	0.15	20.7	SBG822M76145□VA
	8200	76×155	0.15	21.4	SBG822M76155□VA
10000	76×155	0.15	22.0	SBG103M76155□VA	
10000	89×130	0.15	22.8	SBG103M89130□VA	

WV _{DC} (Surge Voltage) (V)	Cap (μ F)	Size D×L (mm)	tan δ 20°C/120Hz	Ripple Current 85°C/120Hz (Arms)	Catalog Part Number
400 (450)	12000	89×157	0.15	25.4	SBG123M89157□VA
	15000	89×195	0.15	30.0	SBG153M89195□VA
450 (500)	1000	51×70	0.15	4.6	SBE102M51070□VA
	1200	51×80	0.15	5.3	SBE122M51080□VA
	1500	51×90	0.15	6.5	SBE152M51090□VA
	1800	51×95	0.15	7.3	SBE182M51095□VA
	2200	51×130	0.15	8.4	SBE222M51130□VA
	2700	64×95	0.15	9.9	SBE272M64095□VA
	3300	64×115	0.15	11.7	SBE332M64115□VA
	3900	64×130	0.15	13.3	SBE392M64130□VA
	3900	76×95	0.15	13.2	SBE392M76095□VA
	4700	64×155	0.15	15.1	SBE472M64155□VA
	4700	76×115	0.15	15.0	SBE472M76115□VA
	5600	76×130	0.15	17.5	SBE562M76130□VA
	6800	76×145	0.15	19.1	SBE682M76145□VA
	6800	76×155	0.15	19.7	SBE682M76155□VA
	8200	76×155	0.15	21.5	SBE822M76155□VA
	8200	89×130	0.15	21.8	SBE822M89130□VA
	10000	89×157	0.15	23.8	SBE103M89157□VA
	10000	89×170	0.15	24.6	SBE103M89170□VA
12000	89×195	0.15	27.9	SBE123M89195□VA	
500 (550)	470	51×60	0.20	2.7	SBC471M51060□VA
	560	51×60	0.20	3.0	SBC561M51060□VA
	680	51×70	0.20	3.6	SBC681M51070□VA
	820	51×80	0.20	4.1	SBC821M51080□VA
	1000	51×90	0.20	5.4	SBC102M51090□VA
	1200	51×95	0.20	5.9	SBC122M51095□VA
	1500	64×95	0.20	6.9	SBC152M64095□VA
	1800	64×95	0.20	8.2	SBC182M64095□VA
	2200	64×115	0.20	9.5	SBC222M64115□VA
	2700	64×130	0.20	11.1	SBC272M64130□VA
	3300	76×115	0.20	12.6	SBC332M76115□VA
	3900	76×120	0.20	13.6	SBC392M76120□VA
	4700	76×145	0.20	16.2	SBC472M76145□VA
	5600	89×130	0.20	17.9	SBC562M89130□VA
	6800	89×157	0.20	20.6	SBC682M89157□VA
	8200	89×195	0.20	23.3	SBC822M89195□VA
	10000	89×220	0.20	27.1	SBC103M89220□VA

*产品编码中□内为产品端子引出型式代码
*□Enter the appropriate terminal code

*记载之外的体积，请另行咨询。
*Please ask for advice for other sizes.

*铝电解电容器由于承受纹波电流而发热，随着温升而发生性能劣化。请在使用中降低产品承受的纹波电流。
*Aluminum electrolytic capacitor will emit heat when ripple current is applied, the performance will deteriorate when temp. rises. Please reduce the ripple current when using capacitor.

Note: All design and specification are for reference only and is subject to change without prior notice. If any doubt about safety for your application, please contact KNSCHA immediately for technical assistance or for purchase.
备注：以上所提供的设计及特性参数仅供参考，任何修改不作预先通知。如果在使用上有疑问，请再购买前与科尼盛联系，以便我们提供技术上的服务和协助。